

**Features**

- Low forward voltage drop
- High reverse voltage
- Hermetic metal cases with ceramic insulators

**Typical Applications**

- All purpose high power rectifier diodes
- High power resistance welding equipment
- Non-controllable and half-controllable rectifiers
- Controlled rectifiers

**$I_{F(AV)}$       2890 A**  
 **$V_{RRM}$         4300~5000 V**  
 **$I_{FSM}$          26 kA**  
 **$I^2t$             3380 10<sup>3</sup>A<sup>2</sup>S**



SYMBOL	CHARACTERISTIC	TEST CONDITIONS	T <sub>j</sub> (°C)	VALUE			UNIT
				Min	Type	Max	
$I_{F(AV)}$	Mean forward current	180° half sine wave 50Hz Double side cooled, T <sub>C</sub> =85°C	150			2890	A
$V_{RRM}$	Repetitive peak reverse voltage	tp=10ms	150	4300		5000	V
$I_{RRM}$	Repetitive peak current	at $V_{RRM}$	150			150	mA
$I_{FSM}$	Surge forward current	10ms half sine wave	150			26	kA
$I^2t$	$I^2t$ for fusing coordination	$V_R=0.6V_{RRM}$				3380	A <sup>2</sup> s*10 <sup>3</sup>
$V_{FO}$	Threshold voltage		150			0.86	V
$r_F$	Forward slope resistance					0.122	mΩ
$V_{FM}$	Peak forward voltage	$I_{FM}=3000A, F=34kN$	150			1.23	V
$Q_{rr}$	Recovery charge	$I_{FM}=2000A, tp=2000\mu s, di/dt=-20A/\mu s, V_R=50V$	150		4500		μC
$R_{th(j-c)}$	Thermal resistance Junction to case	DC double side cooled				0.013	°C /W
$R_{th(c-h)}$	Thermal resistance case to heatsink	Clamping force 34kN				0.0035	
$F_m$	Mounting force			27		34	kN
$T_{stg}$	Stored temperature			-40		160	°C
$W_t$	Weight				820		g
Outline	P44						

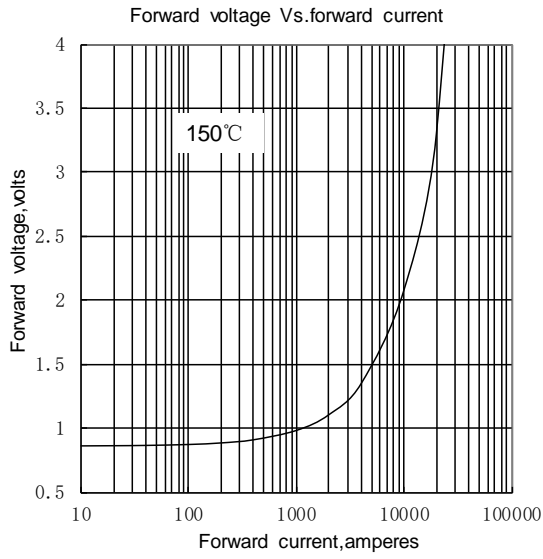

Fig.1

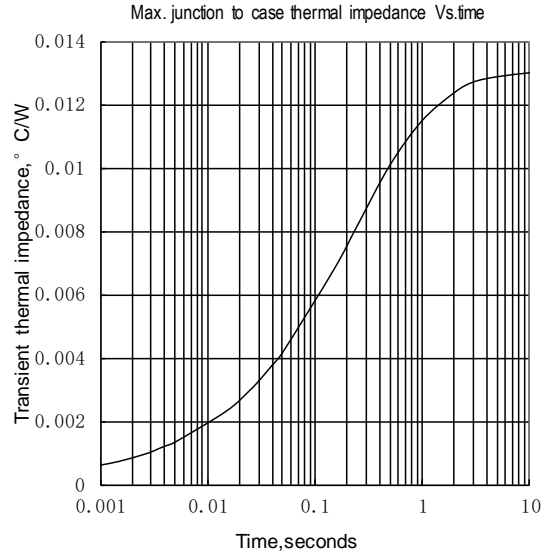

Fig.2

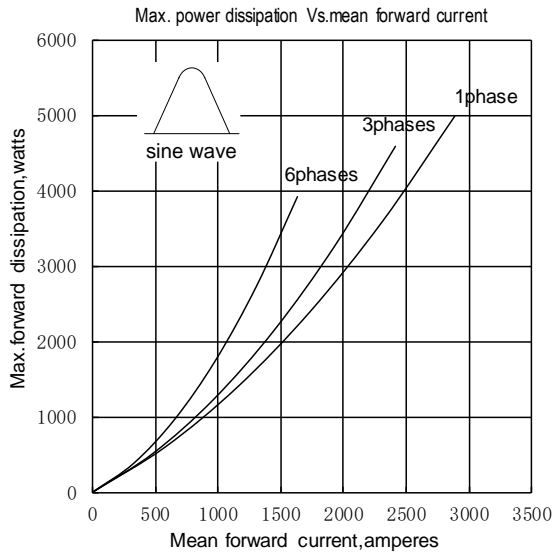

Fig.3

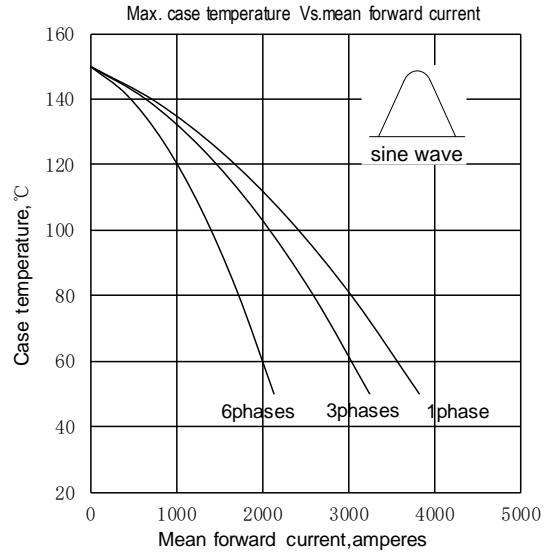

Fig.4

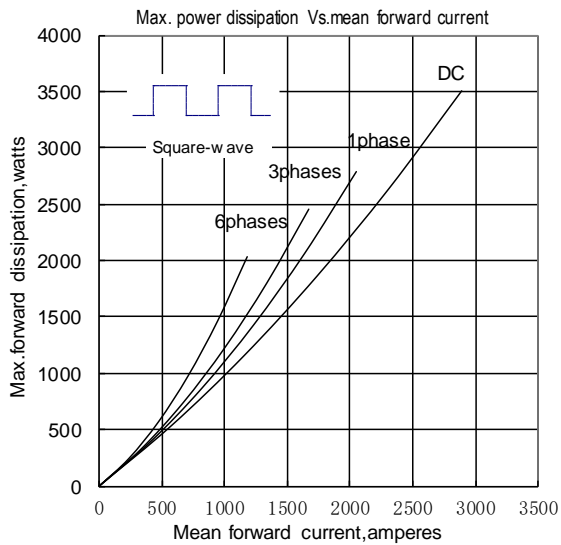

Fig.5

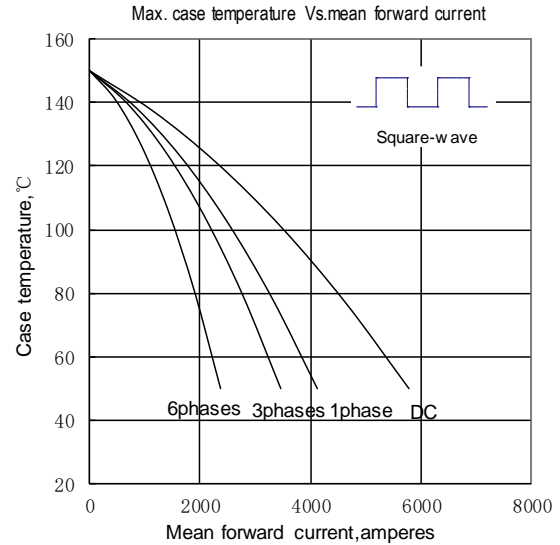

Fig.6

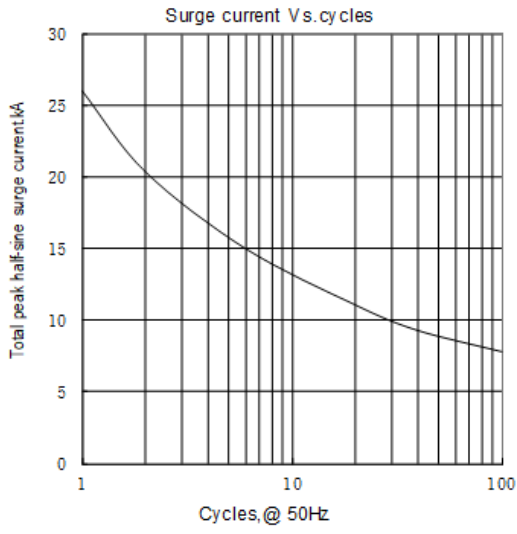
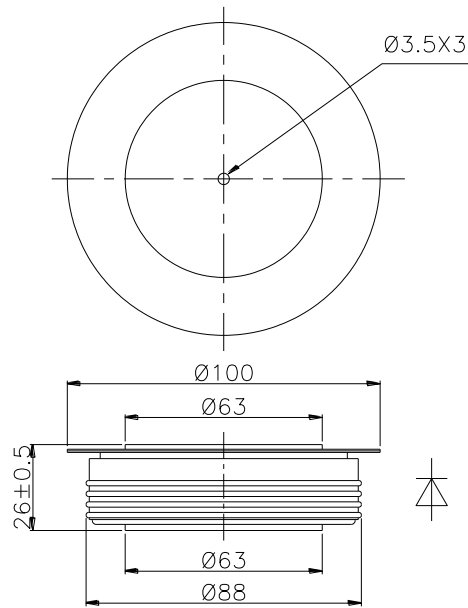

Fig.7



Nlps reserves the right to change specifications without notice.