

**Features**

- International standard package
- Planar glassivated chips

**Typical Applications**

- High power rectifiers
- Field supply for DC motors
- Power supplies

<b>I<sub>F(AV)</sub></b>	<b>60A</b>
<b>V<sub>RRM</sub></b>	<b>1000V 1200V 1600V</b>
<b>I<sub>FSM</sub></b>	<b>600 A</b>
<b>I<sup>2</sup>t</b>	<b>1800 A<sup>2</sup>s</b>

SYMBOL	CHARACTERISTIC	TEST CONDITIONS		T <sub>j</sub> (°C)	VALUE			UNIT
					Min	Type	Max	
I <sub>F(AV)</sub>	Mean forward current	180° half sine wave 50Hz Double side cooled,	T <sub>C</sub> =100°C	175			60	A
I <sub>T(RMS)</sub>	RMS on-state current						94	A
V <sub>RRM</sub>	Repetitive peak reverse voltage	tp=10ms		175	1000		1600	V
I <sub>RRM</sub>	Repetitive peak current	at V <sub>RRM</sub>		175			10	mA
I <sub>FSM</sub>	Surge forward current	10ms half sine wave		175			600	A
I <sup>2</sup> t	I <sup>2</sup> t for fusing coordination	V <sub>R</sub> =0.6V <sub>RRM</sub>					1800	A <sup>2</sup> s
V <sub>FO</sub>	Threshold voltage			175			0.85	V
r <sub>F</sub>	Forward slope resistance						2.3	mΩ
V <sub>FM</sub>	Peak forward voltage	I <sub>FM</sub> =180A		175			1.30	V
R <sub>th(j-c)</sub>	Thermal resistance Junction to case	Clamping force 2.4kN					1.08	°C /W
F <sub>m</sub>	Mounting force					2.4	2.9	kN
T <sub>stg</sub>	Stored temperature				-40		175	°C
T <sub>jm</sub>	Junction temperature				-40		175	°C
W <sub>t</sub>	Weight					15		g
Outline	ZP01/ZP01A							

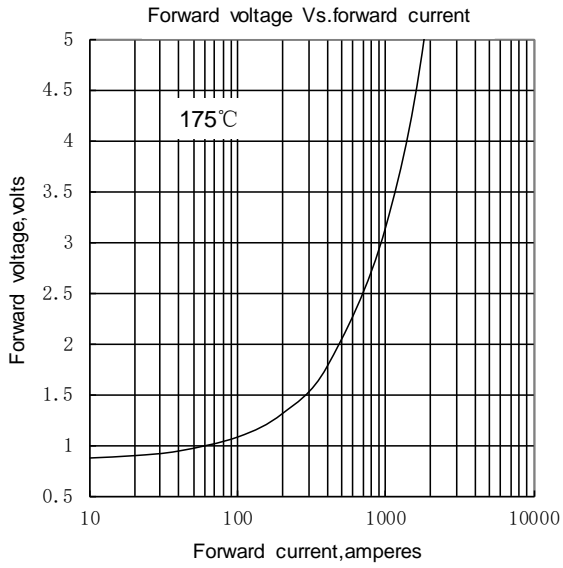

Fig.1

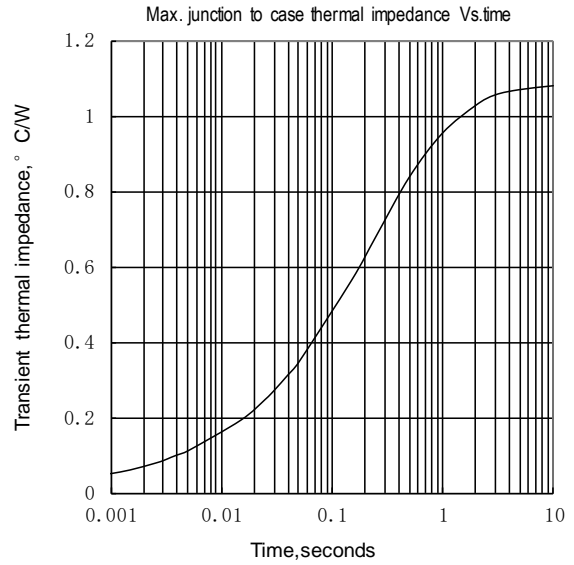

Fig.2

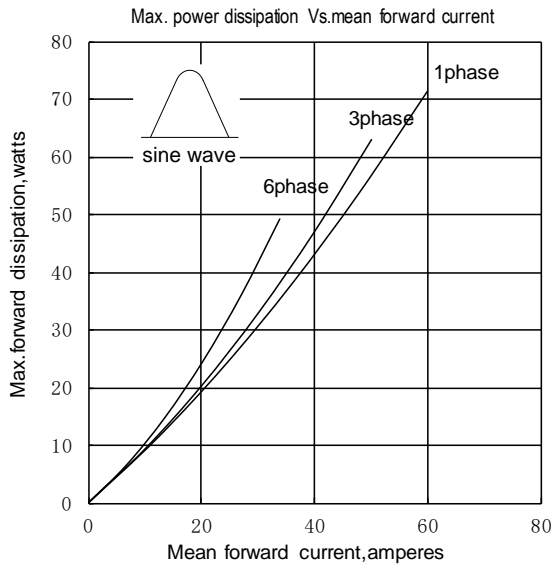

Fig.3

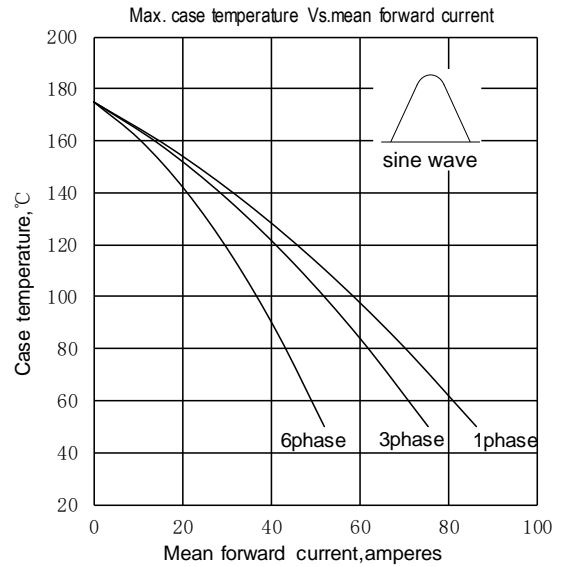

Fig.4

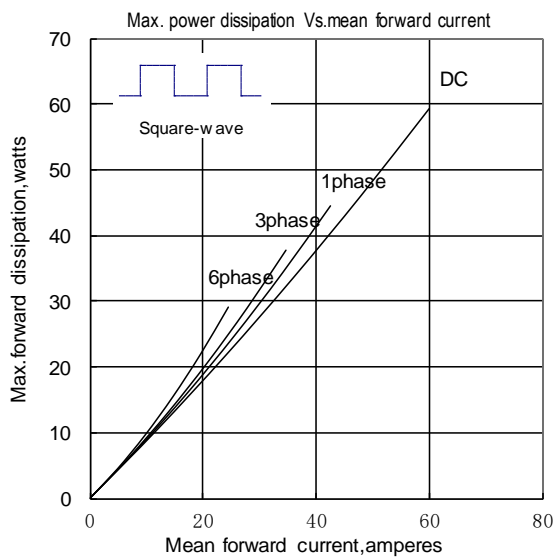

Fig.5

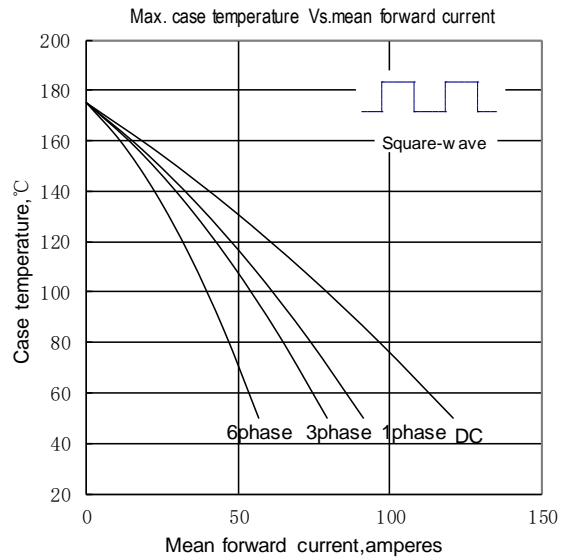

Fig.6

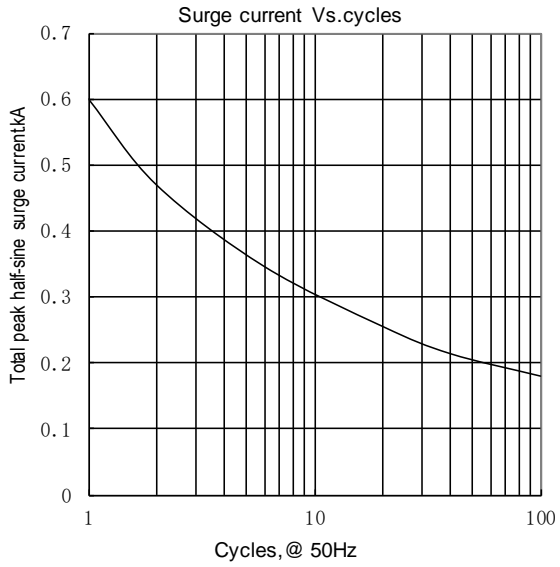

Fig.7

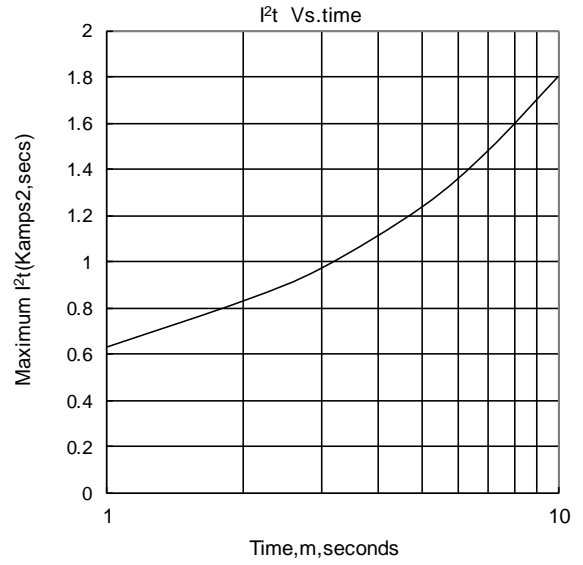
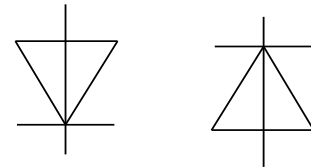
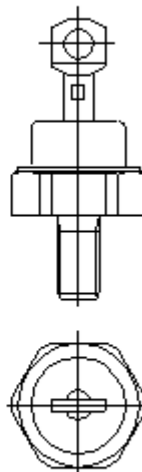
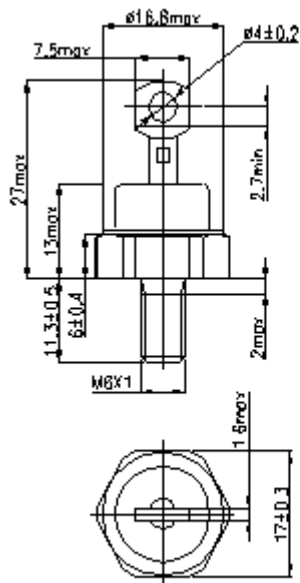

Fig.8



SH60D\*\*SK SH60D \* \* SA